

## Parts List

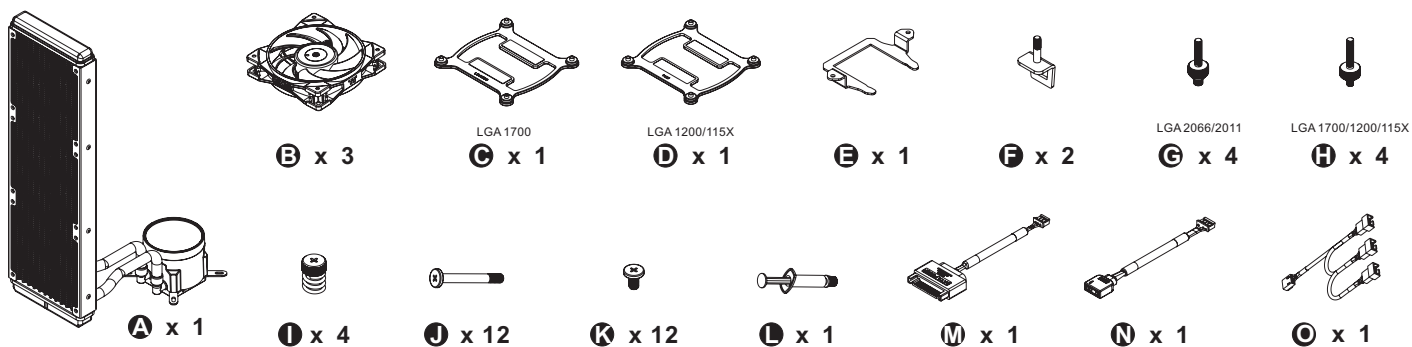
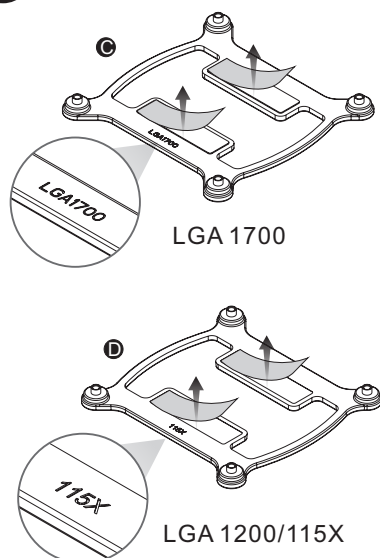

## Intel Installation Guide

**1**

**2**

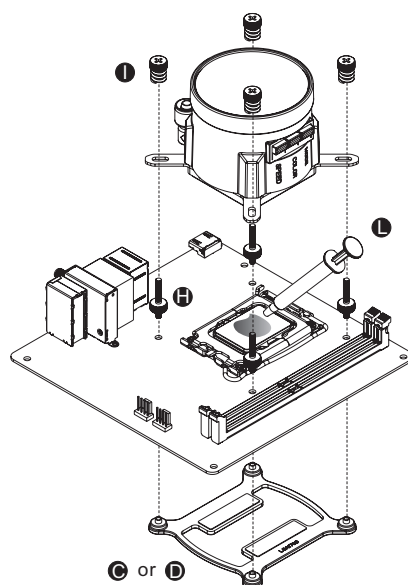
1700/1200/1156/1155/1151/1150

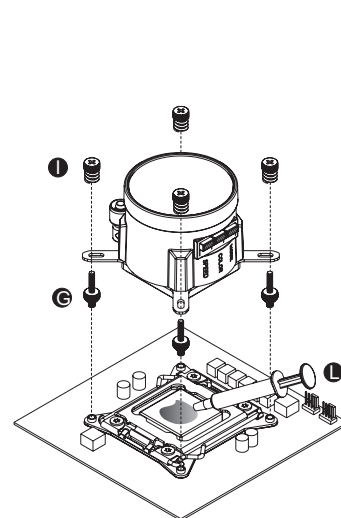

2066/2011-3/2011

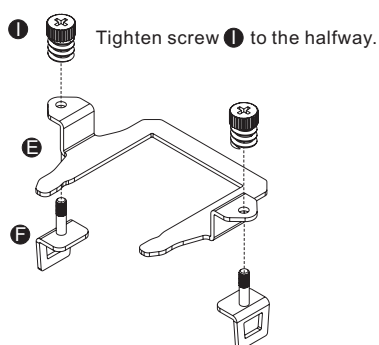
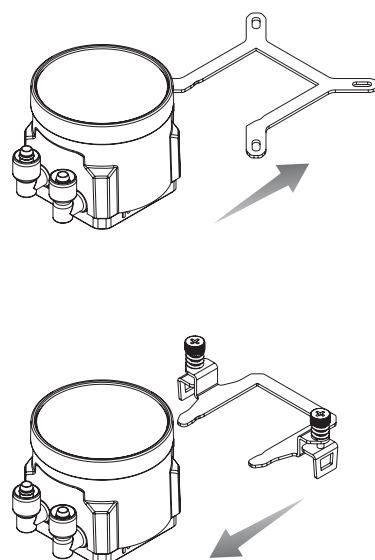

## AMD Installation Guide

**1**

**2**

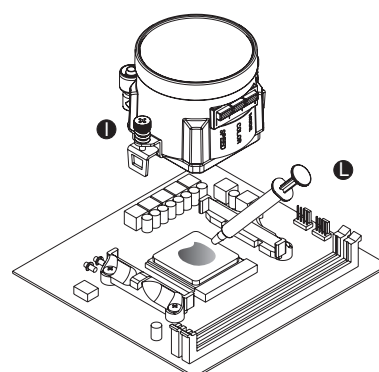
**3**

Tighten screw **I** again to ensure your waterblock is secure enough.

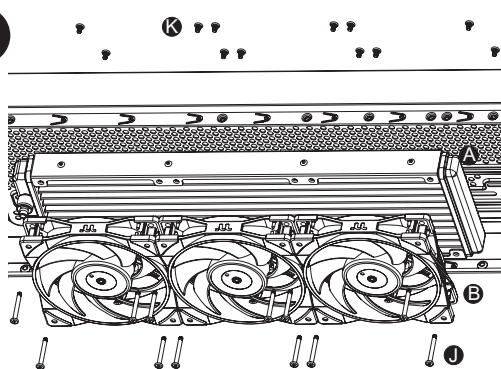

# Installation Guide

1



2

Intel

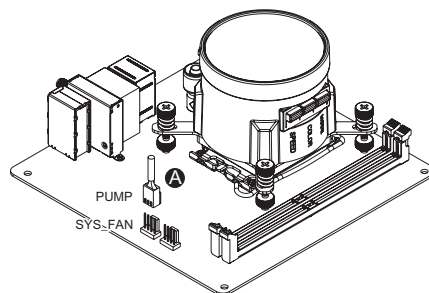

AMD

or

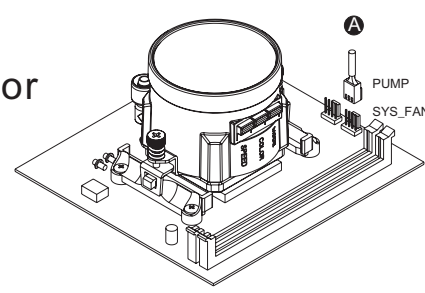

3

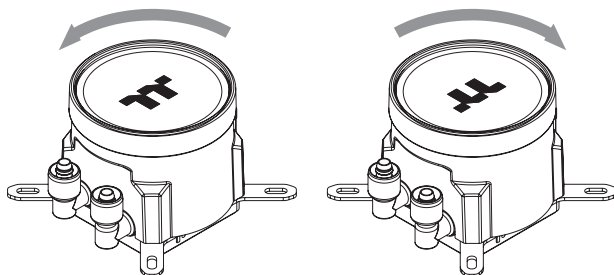

A rotatable LED cap built-in waterblock accommodates re-orienting the logo no matter the direction the cooler is installed

4

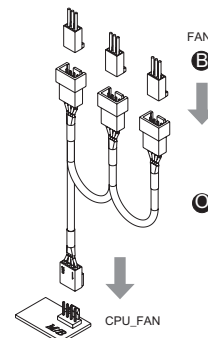

## ARGB Controller Installation Guide

1

### CAUTION

To use the ARGB Controller, please only connect Cable E to the water block

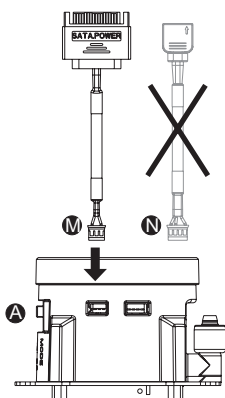

2

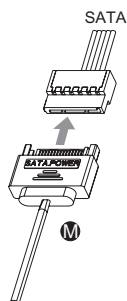

3

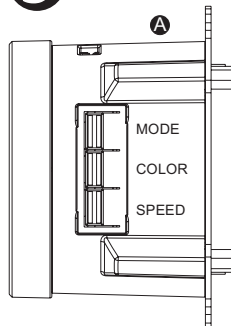

### 1. Light Mode:

Switch over between 7 LED modes.

Rainbow → Full light → RGB Spectrum → Off → Flow → Radar → Pulse → Blink

### 2. Color Mode:

**When light mode is in Full Lighted, Pulse and Blink :**

Switch over 8 LED colors .

Red → Yellow → Green → Teal → Blue → White → Purple → Rainbow

**When light mode is in Ripple :**

Switch over 7 LED colors .

Red → Yellow → Green → Teal → Blue → White → Purple

**When light mode is in RGB Spectrum:**

Click to memorize and lock the color you want, click again to unlock the 256 colors auto rotation.

**When light mode is in Wave and Flow :**

LED color can not be adjusted.

### 3. Light Speed:

Switch over between 4 light modes.

Slow → Normal → Fast → Extreme

## MB SYNC Installation Guide

### CAUTION

1. To use Motherboard RGB Software, please only connect Cable F to the water block
2. Please power off the PC and check the Positive and Negative ends on the connector before connecting the cable to the mainboard. Connecting the wrong end can damage the product.

1

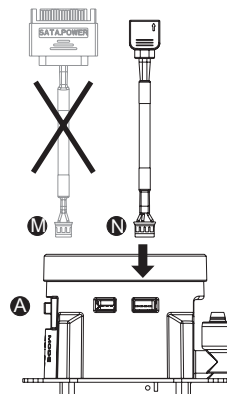

2

