

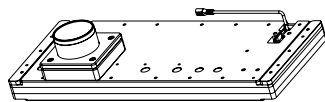

This product is intended for installation only by expert users. Please consult with a qualified technician for installation. Improper installation may result in damage to your equipment.

1. Please carefully read the manual before beginning the installation process !
2. It is strongly recommended to use market proven pre-mix coolant, such as Thermaltake Coolant 1000.
3. DO NOT USE any kind of alcohol or alcohol derivatives with this reservoir or the acrylic tube may crack and fail ! Do not clean it using alcohol either

## Parts List



**A x 1**  
Distro Plate

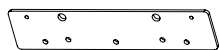

**B x 2**  
Bracket



**C x 4**  
Screw



**D x 3**  
G1/4 Stop Plug



**E x 1**  
Wrench



**F x 1**  
Controller

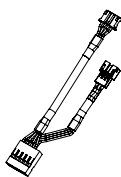

**G x 1**  
LED Y-Cable

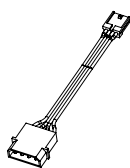

**H x 1**  
Power Cable

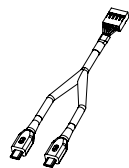

**I x 1**  
Controller Cable



**J x 1**  
Bridge Cable

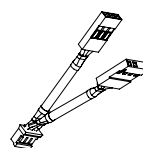

**K x 1**  
MB SYNC Cable

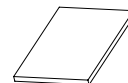

**L x 1**  
Velcro

## Installation Guide

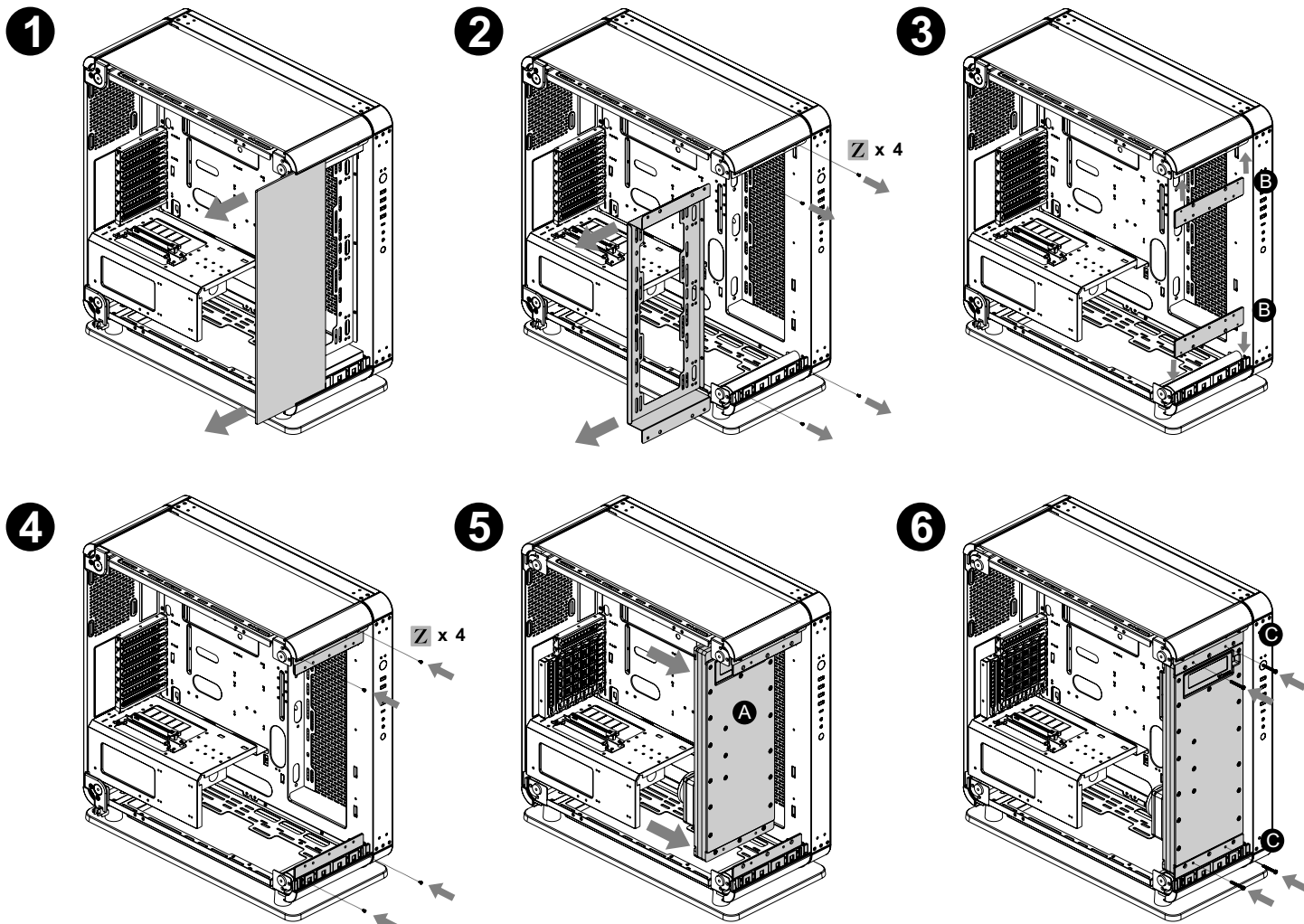

# Installation Guide

7

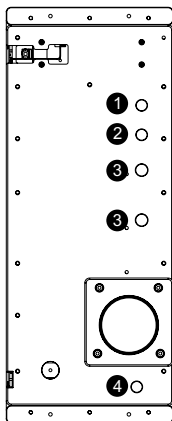

## Circle 1

Designed for liquid fill, you may choose one of the ports to use.

## Circle 2

Designed for liquid inlet, you may choose one of the ports to use.

## Circle 3

Designed for liquid outlet, you may choose one of the ports to use.

## Circle 4

The drain port.

8

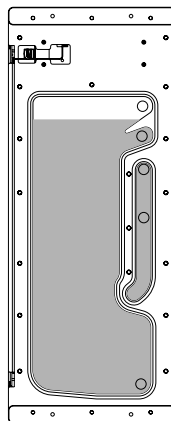

To avoid air bubble during liquid cooling system working, please fill the reservoir with coolant to the line (Normal coolant level)

9

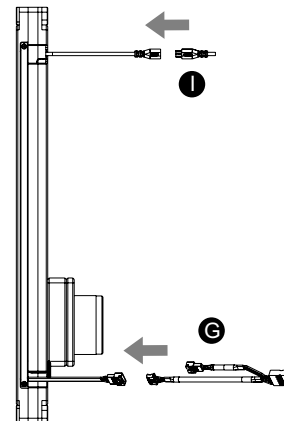

## Mainboard SYNC installation Guide

### CAUTION

Please power off the PC and check the Positive and Negative ends on the connector before connecting the cable to mainboard. Connecting the wrong end can damage the LEDs.

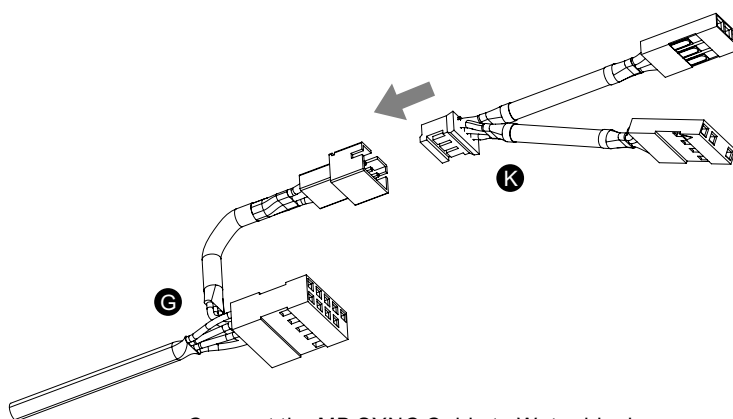

Connect the MB SYNC Cable to Water block

### ASUS

Aura Addressable Strip Header(s)

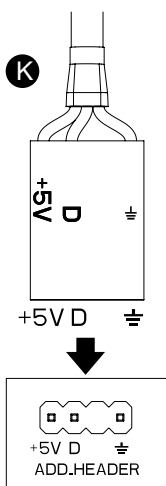

### MSI

JRGB-strip Header(S)

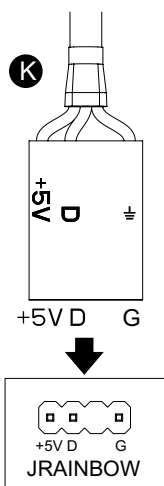

### ASROCK

Addressable RGB LED Header(s)

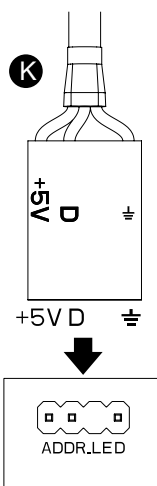

### GIGABYTE

AOURS RGB Fusion with Digital LEDs

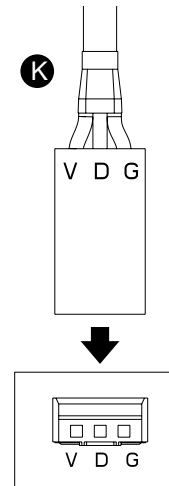



## Controller Installation Guide

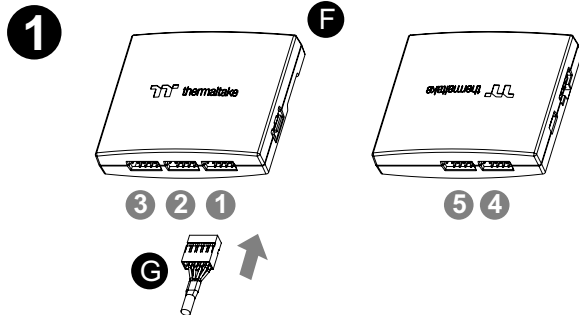

Connect the reservoir cable onto the controller.

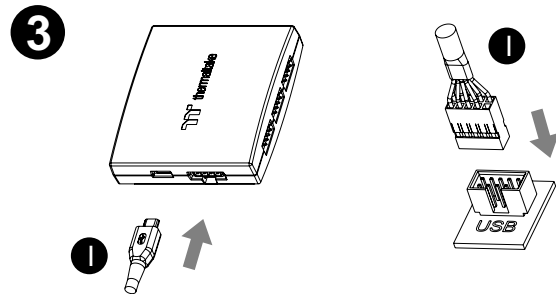

Connect the controller cable onto the mainboard (USB 2.0 9 pin) and controller.

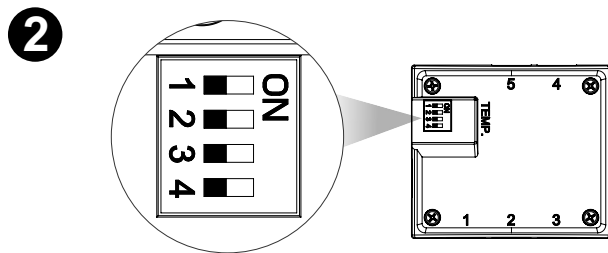

Set the DIP switch on the back side of the controller to assign the number of the controller

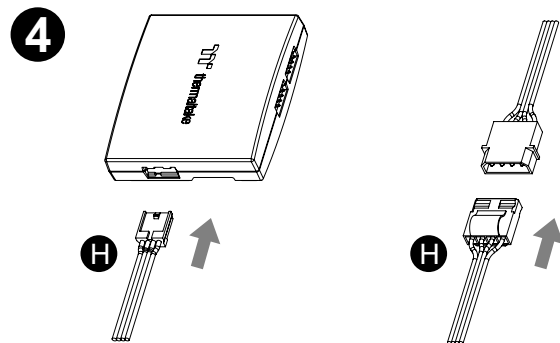

Connect the power cable to the 4pin Molex connector and controller.

<b>NO.1</b> ON  1 2 3 4	<b>NO.2</b> ON  1 2 3 4	<b>NO.3</b> ON  1 2 3 4	<b>NO.4</b> ON  1 2 3 4
<b>NO.5</b> ON  1 2 3 4	<b>NO.6</b> ON  1 2 3 4	<b>NO.7</b> ON  1 2 3 4	<b>NO.8</b> ON  1 2 3 4
<b>NO.9</b> ON  1 2 3 4	<b>NO.10</b> ON  1 2 3 4	<b>NO.11</b> ON  1 2 3 4	<b>NO.12</b> ON  1 2 3 4
<b>NO.13</b> ON  1 2 3 4	<b>NO.14</b> ON  1 2 3 4	<b>NO.15</b> ON  1 2 3 4	<b>NO.16</b> ON  1 2 3 4

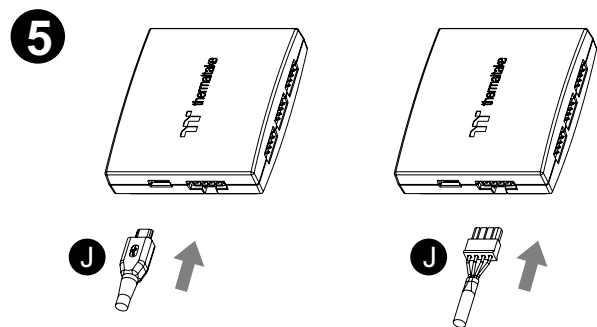

If you want to connect two or more connectors, you can use the bridge cable to connect the controllers.